

## Product Information

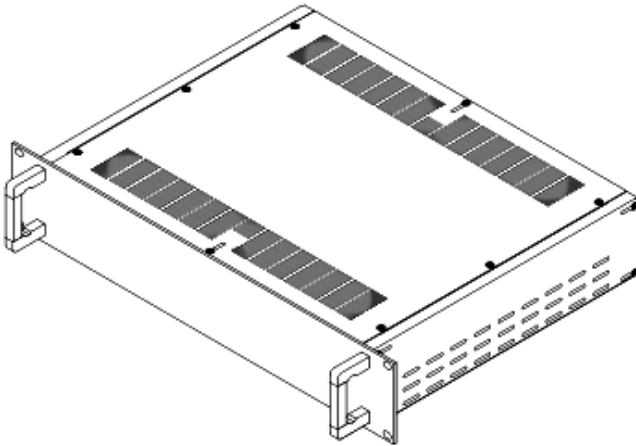

The PF-19 Series of rack mounted 19" Enclosures, like its companion SA Series, is designed for both the industrial and home hobbyists. PF-19 is a heavy duty enclosure which can be installed into any standard 19" rack or using the rubber feet provided, set on any surface. The high quality steel body features removable top and bottom panels, which are liberally vented so your components stay cool. The 3.00 mm thick Aluminum front panel is stout but easily worked by the user. Inside front steel plate and multi holed mounting rails, allow for convenient PCB and component installation.

### Features

- Complies with IEC 297, EIA RS-310 C1977, DIN41494; allows complete compatibility with all 19" standard equipment.
- Careful design allows for easy modification to the customer's requisites.
- Wide range of applications; the PF-19 system consists of 5 sizes from 1U to 5U and 3 different depth.
- Easy access for user interface.
- Quick assembly
- Packed flat for convenient shipment and storage.
- RoHS compliance
- Conforms to ASTM D610-01 and ASTM B117 (500 hours salt spray test)

### Materials/Finish

- High grade cold rolled steel 0.9 mm thickness.
- Aluminum on Front and Rear panel
- Powder coat finish preceded by 5 stage iron phosphate pretreatment.
- Standard color is low gloss black. Special colors upon request.

#### Cheval Electronic Enclosure Co., Ltd.

Product Information

Dimensions

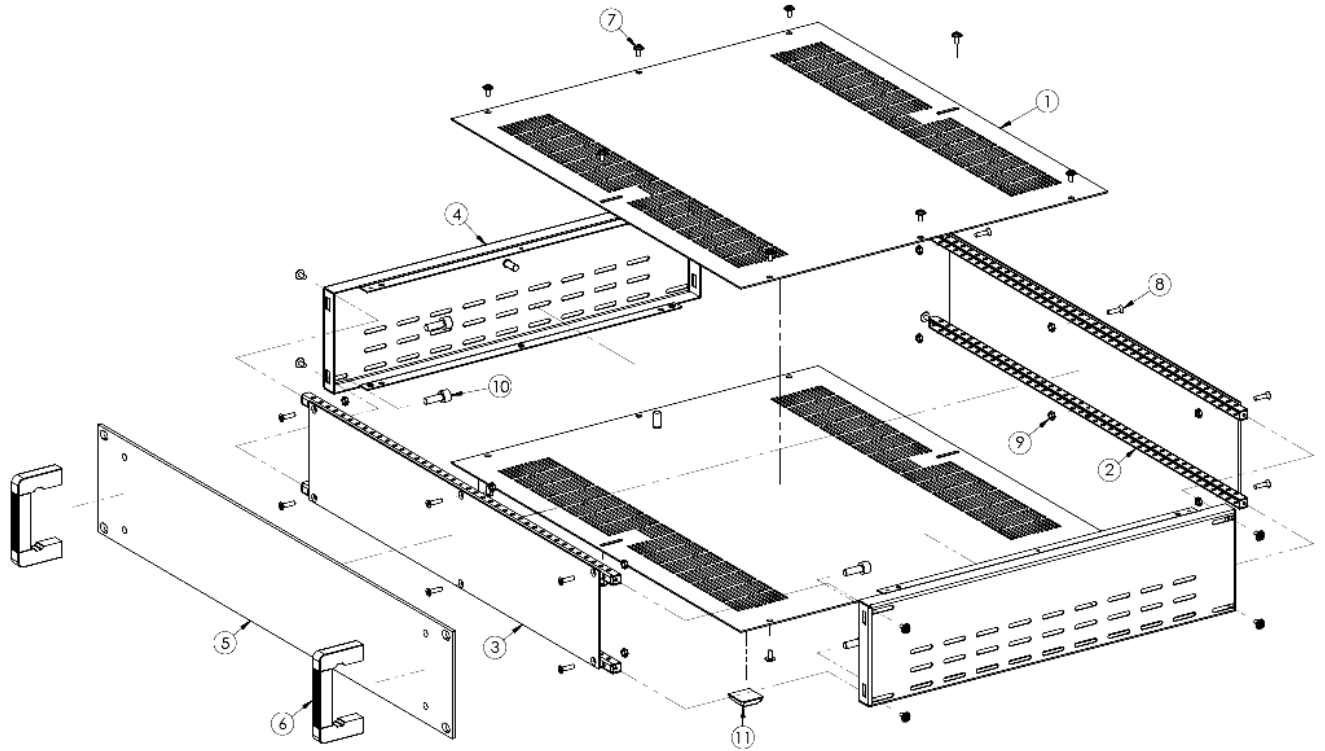

Part List

Item	Material	Contents of Kit				
		1U	2U	3U	4U	5U
1. Top / Base Panel	Mild steel 1.2 MM	2	2	2	2	2
2. General Purpose Bar	Zinc plate steel 0.9 MM	4	4	4	4	4
3. Inside Front/ Rear Panel	AL (0.9/1.2 MM)	2 (0.9)	2 (0.9)	2(1.2)	2(1.2)	2(1.2)
4. Side Panel	Mild Steel 0.9 MM	2	2	2	2	2
5. Front Panel	AL 3.0 MM	1	1	1	1	1
6. Handle	AL extruded	2	2	2	2	2
7. Umbrella Phillips screw	M3x6	28	28, 32	16	16	16
8. Umbrella Phillips screw	M4x8	-	-	16	16	16
9. Flat Head screw	M3x12 with nut	12	12	-	-	-
10. Flat Head screw	M3x15	-	-	12	12	12
11. Round Head screw	M5x15 with nut	-	4	4	4	4
12. Hex screw	M5x15 with nut	4	-	-	-	-

Product Information

Dimensions

There are 24 different sizes and configurations which are available in :

- Height : 1U to 5U (B)
- Width : 203, 305 and 432 mm (W1, W2, W3) (A)
- Depth : 178 and 279 mm (D1, D2) (D)

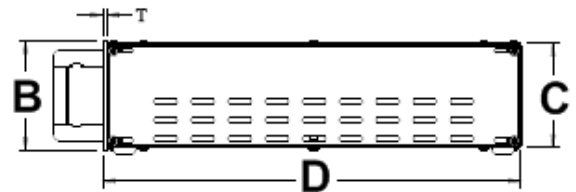
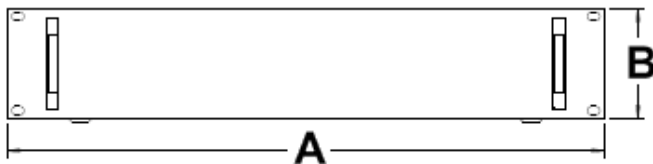
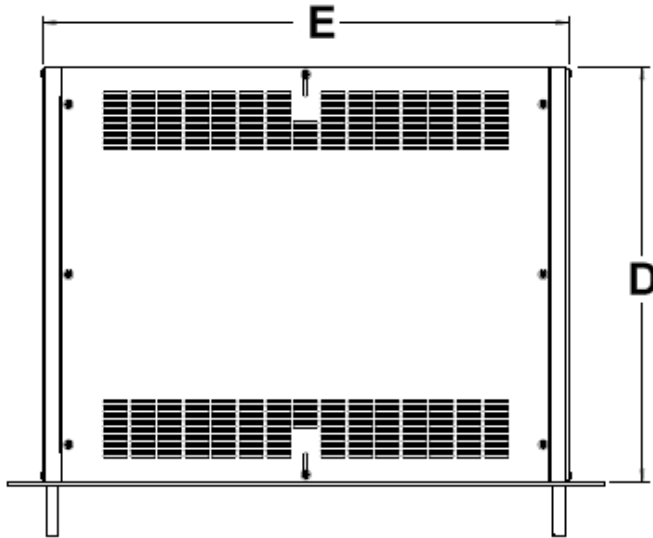

Model	Front Panel (A x B)	Handle Height	Cabinet (E x D x C)
1U-D1	482.6 x 43.7	25	425 x 245 x 38.7 mm
2U-D1	482.6 x 88.1	60	425 x 245 x 83.1 mm
2U-D2	482.6 x 88.1	60	425 x 335 x 83.1 mm
3U-D2	482.6 x 132.6	90	425 x 335 x 127.6 mm
3U-D3	482.6 x 132.6	90	425 x 425 x 127.6 mm
4U-D2	482.6 x 177.0	130	425 x 335 x 172 mm
4U-D3	482.6 x 177.0	130	425 x 425 x 172 mm
5U-D3	482.6 x 221.5	130	425 x 425 x 216.5 mm